

2 in 1 Desk Mount

All-Purpose Router Antenna

The portable 2 in 1 Desk mount MiMo 2G/3G/4G LTE antenna provides an innovative and future proof solution for 2G/3G/4G LTE networks covering 698-960 / 1710-2700Mhz. Incorporating two separately fed ultra wideband elements in a single housing the antenna is equipped to provide portable MiMo and diversity support for the networks of today and tomorrow.

The 2 in 1 desk antenna is highly portable and features desk mount feet which fold out for use, and flat for transport. A handy suction window mount enables users to optimize their signal in multiple locations, with instant installation and easy removal.



Applications:



Failover



Retail



Gas /
Convenience Store



Laptop

Electrical Data

Frequency Range	Element 1 Element 2	698-960 / 1710-2700 698-960 / 1710-2700
Operational Bands	2G/3G/4G LTE	
Radiation Pattern	Omni-directional	
VSWR	< 2.5:1	
Peak Gain (excl. cable loss) †	698-960 MHz	2.5dBi
	1710-2170 MHz	4dBi
	2396-2700 MHz	3dBi
Efficiency (excl. cable loss - all bands)	698-960 MHz	> 50%
	1710-2170 MHz	> 80%
	2396-2700 MHz	> 65%
Correlation Co-efficient (all bands)	< 0.1	
Nominal Impedance	50Ω	
Max Input Power	2W	

† Peak gain simulated off a groundplane and does not include cable attenuation

Mechanical Data

Dimensions	Height Width	5.4" (137mm) 5.94" (151mm)
Operating Temperature	-40° / 176°F (-40° / +80°C)	
Material	U.V. stable, impact resistant ASA	
Color	RAL9005 - Jet Black	
Weight	250g	

Cable Data

Type	CELL RG174
Length	6.5ft (2m)
Termination	SMA Plug

Mounting Data

Mounting Type	Desk mount / Screen clip window mount
---------------	--

TECHNICAL DRAWING

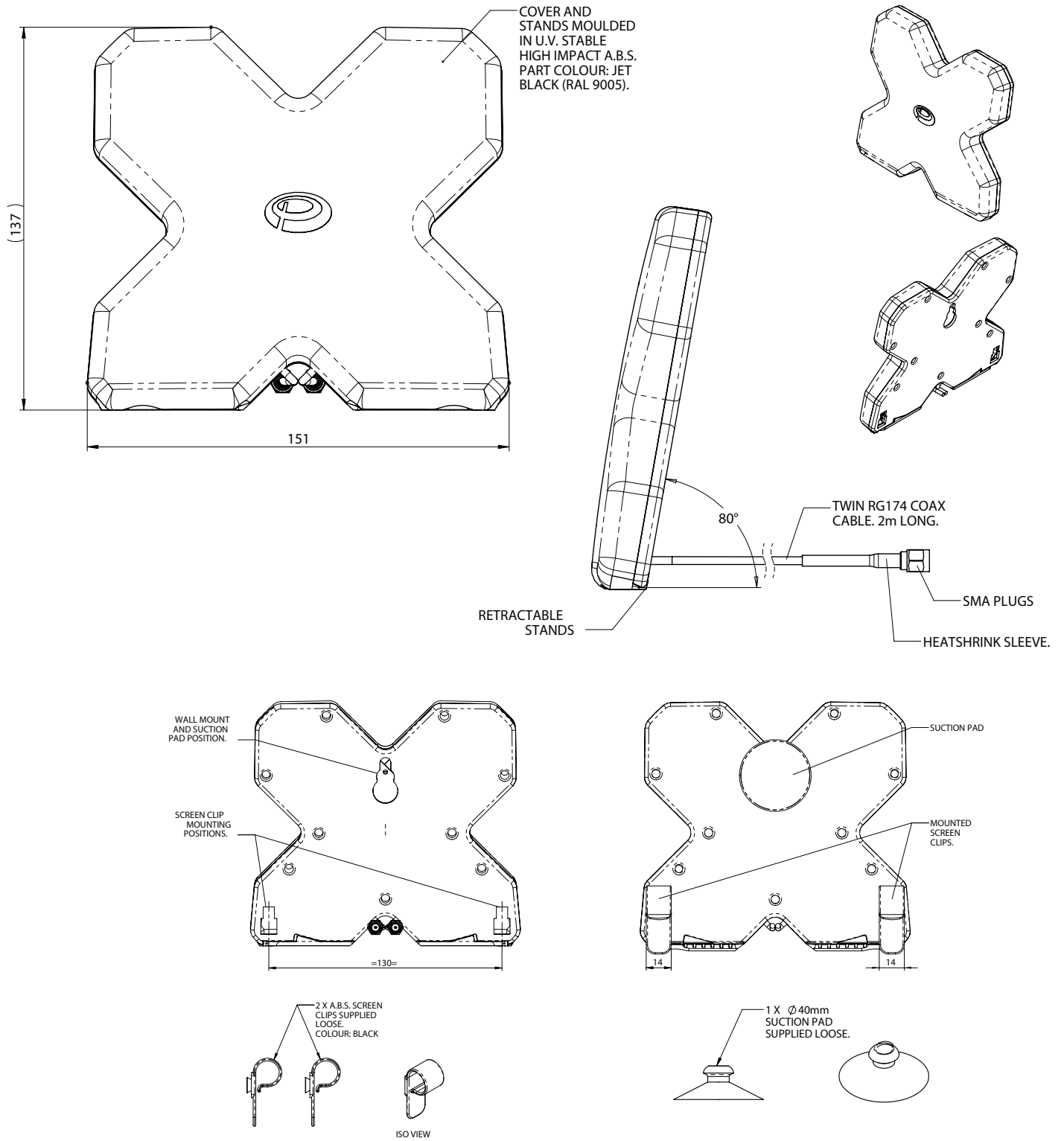

ELECTRICAL DATA

VSWR

Typical VSWR - 2G/3G/4G LTE Elements Elements 1 & 2 *

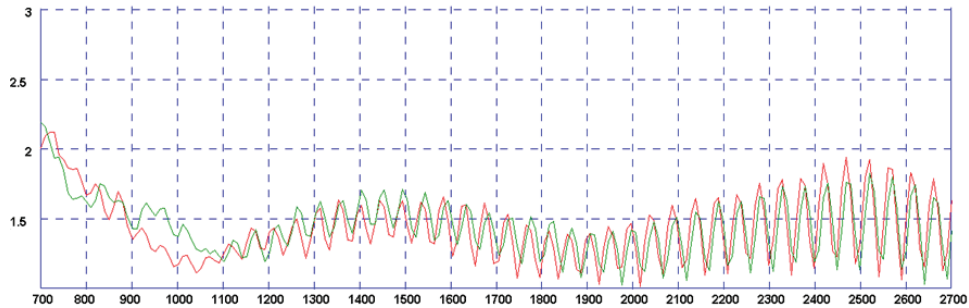

*VSWR Measured with 2m (6ft) of RG174 cable

EFFICIENCY

Typical Element Efficiency - 2G/3G/4G LTE Elements 1 & 2 *

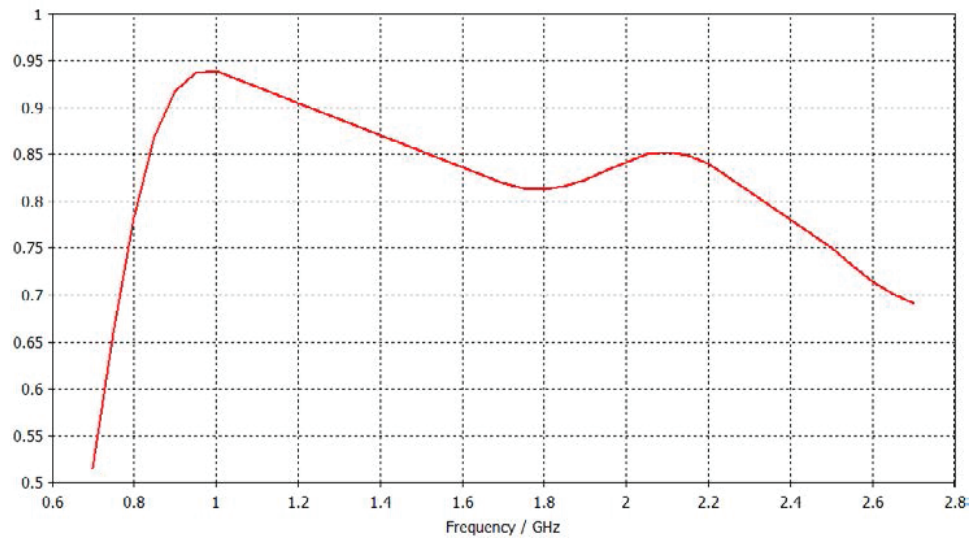

Typical Correlation Co-efficient 2G/3G/4G LTE Elements 1 & 2 *

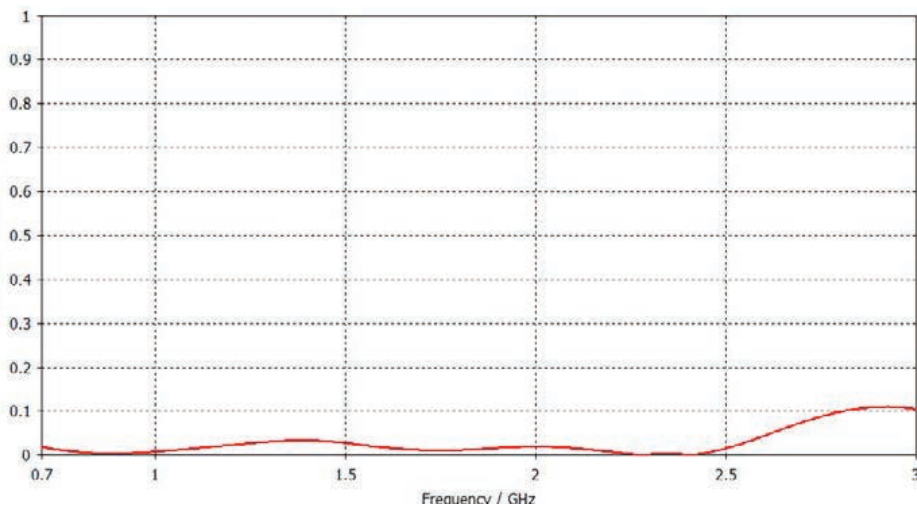

* Element efficiency and correlation co-efficient simulated in CST Microwave Studio without cable loss

RADIATION PATTERNS

3D RADIATION PATTERNS - 2G/3G/4G LTE ELEMENTS 1 & 2*

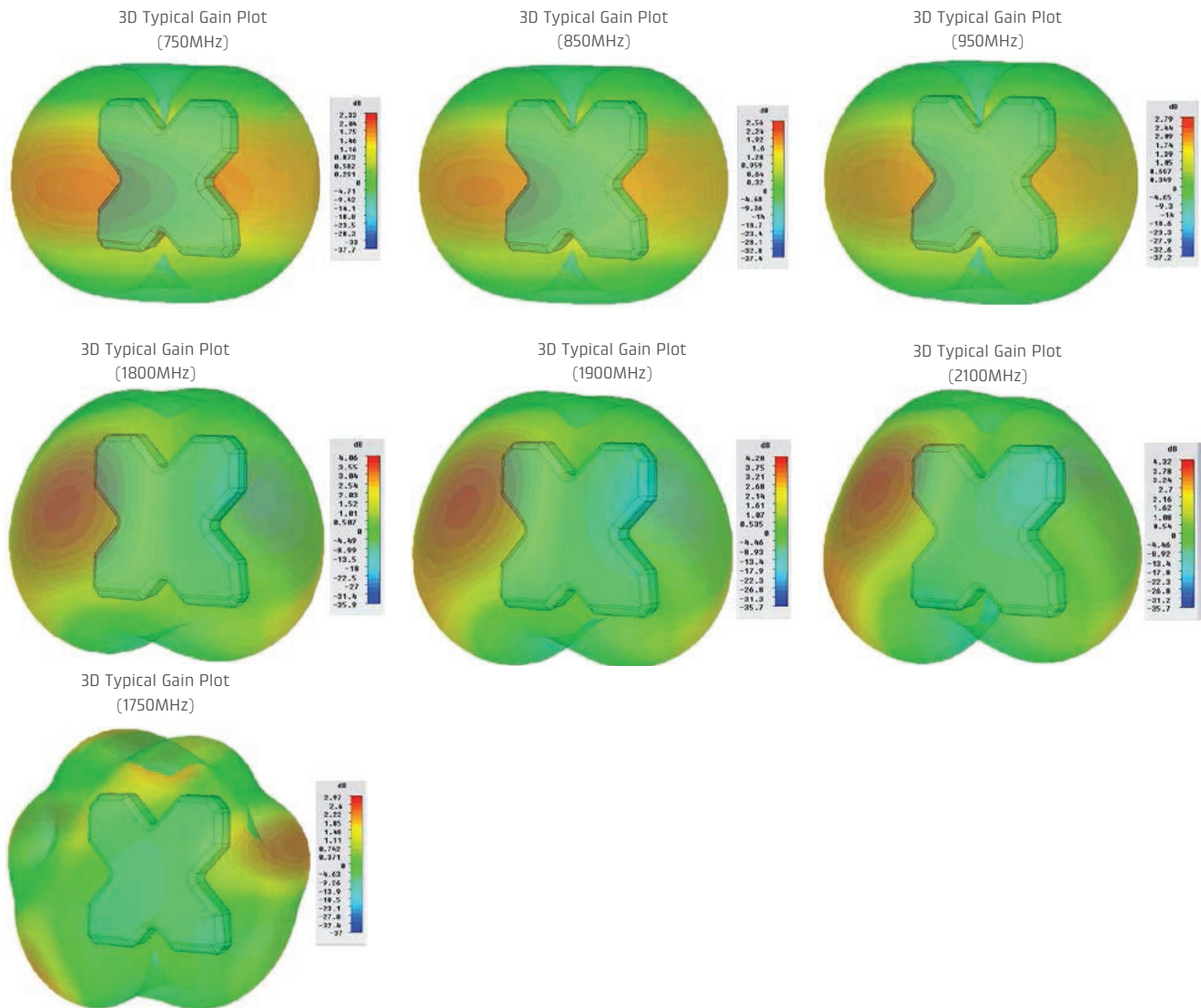

*All pattern and gain measurements taken on a 400 x 400mm (2' x 2') ground plane without additional cable.

FOR MORE INFORMATION, VISIT CRADLEPOINT.COM